

SIGHT DISTANCE SUMMARY TABLE					
ROADWAY DESIGN SPEED	48 MPH	AVAILABLE SIGHT DISTANCE (FT)		AASHTO SIGHT DISTANCES	
		EXISTING	PROPOSED	STOPPING SIGHT DISTANCE (FT)	INTERSECTION SIGHT DISTANCE (FT)
LEFT TURN FROM SITE ACCESS	LOOKING LEFT	565+	565+	400	565
	LOOKING RIGHT	565+	565+	490	565

NOTES:
 1) BASED ON THE AMERICAN ASSOCIATION OF STATE HIGHWAY AND TRANSPORTATION OFFICIALS (AASHTO), 7TH EDITION 2018.
 2) AASHTO SIGHT DISTANCES ARE BASED ON 48 MPH OPERATING SPEED ALONG THE ROADWAY IN THE VICINITY OF THE SITE ACCESS LOCATION FOR PASSENGER CARS, ADJUSTED FOR GRADES AND PROPOSED TWO-WAY LEFT TURN LANE.
 3) AVAILABLE SIGHT DISTANCES SHOWN ARE FOR EXISTING CONDITIONS AND FOR FUTURE CONDITIONS AFTER COMPLETION OF ANY IMPROVEMENTS SUCH AS VEGETATIVE PRUNING/CLEARING AND GRADING.

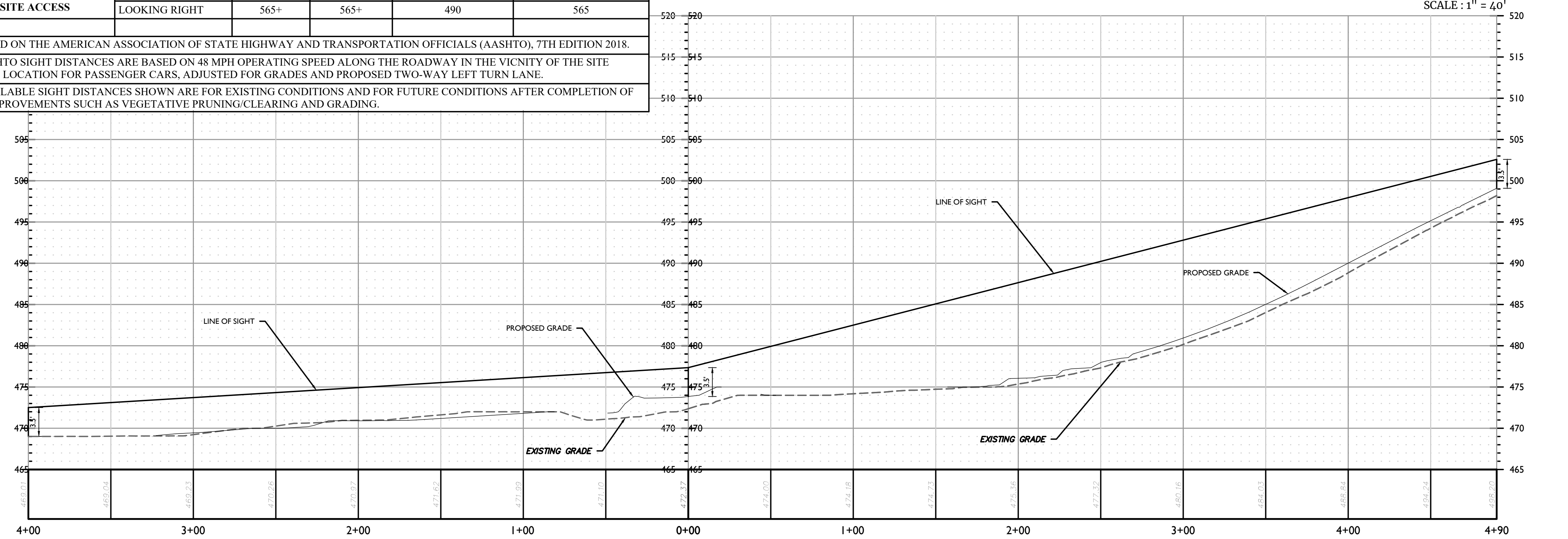

PROFILE OF SSD LOOKING LEFT (SOUTH DRIVE)
 HORIZONTAL : 1" = 40'
 VERTICAL : 1" = 8'

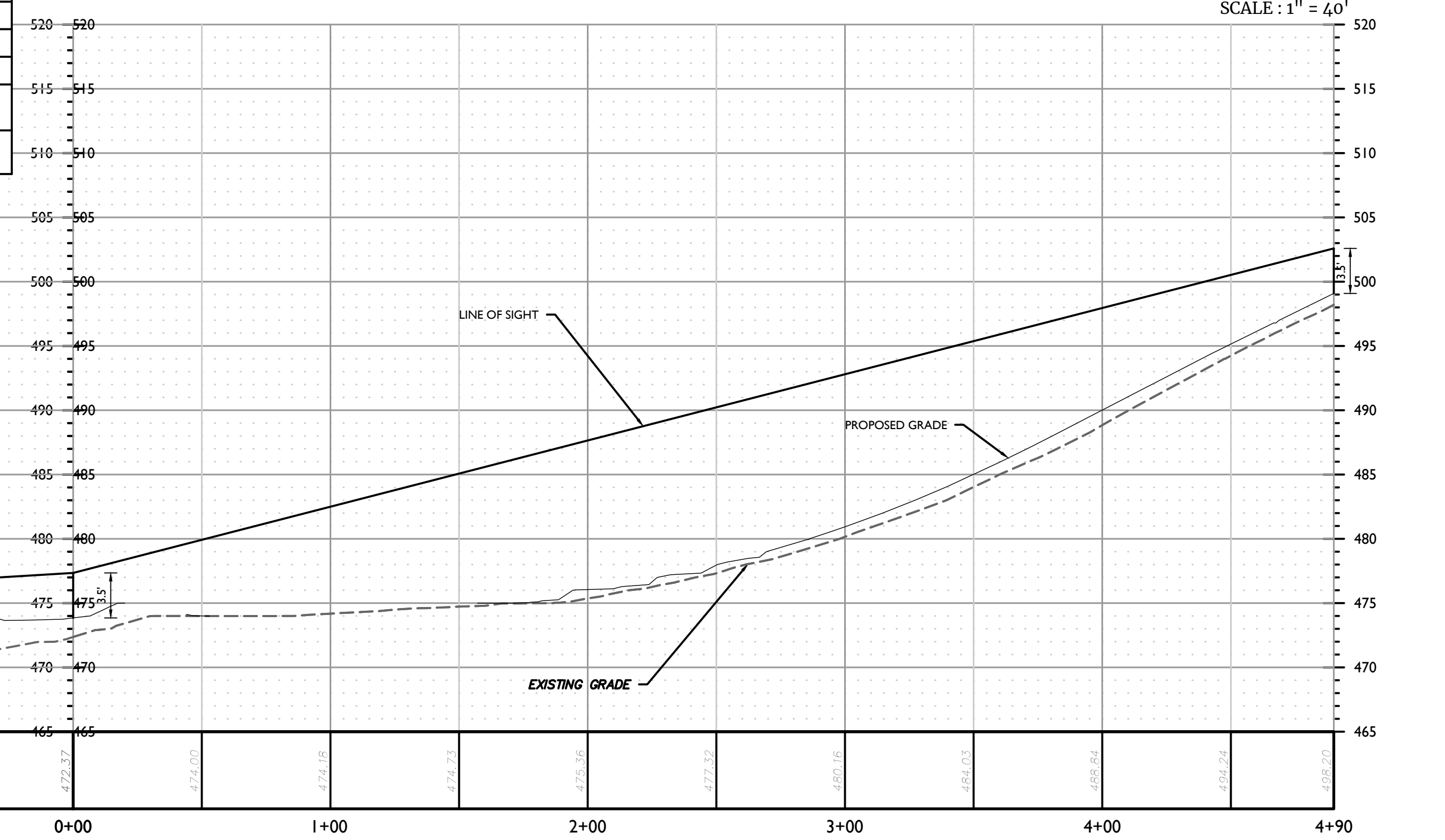

PROFILE OF SSD LOOKING RIGHT (SOUTH DRIVE)
 HORIZONTAL : 1" = 40'
 VERTICAL : 1" = 8'

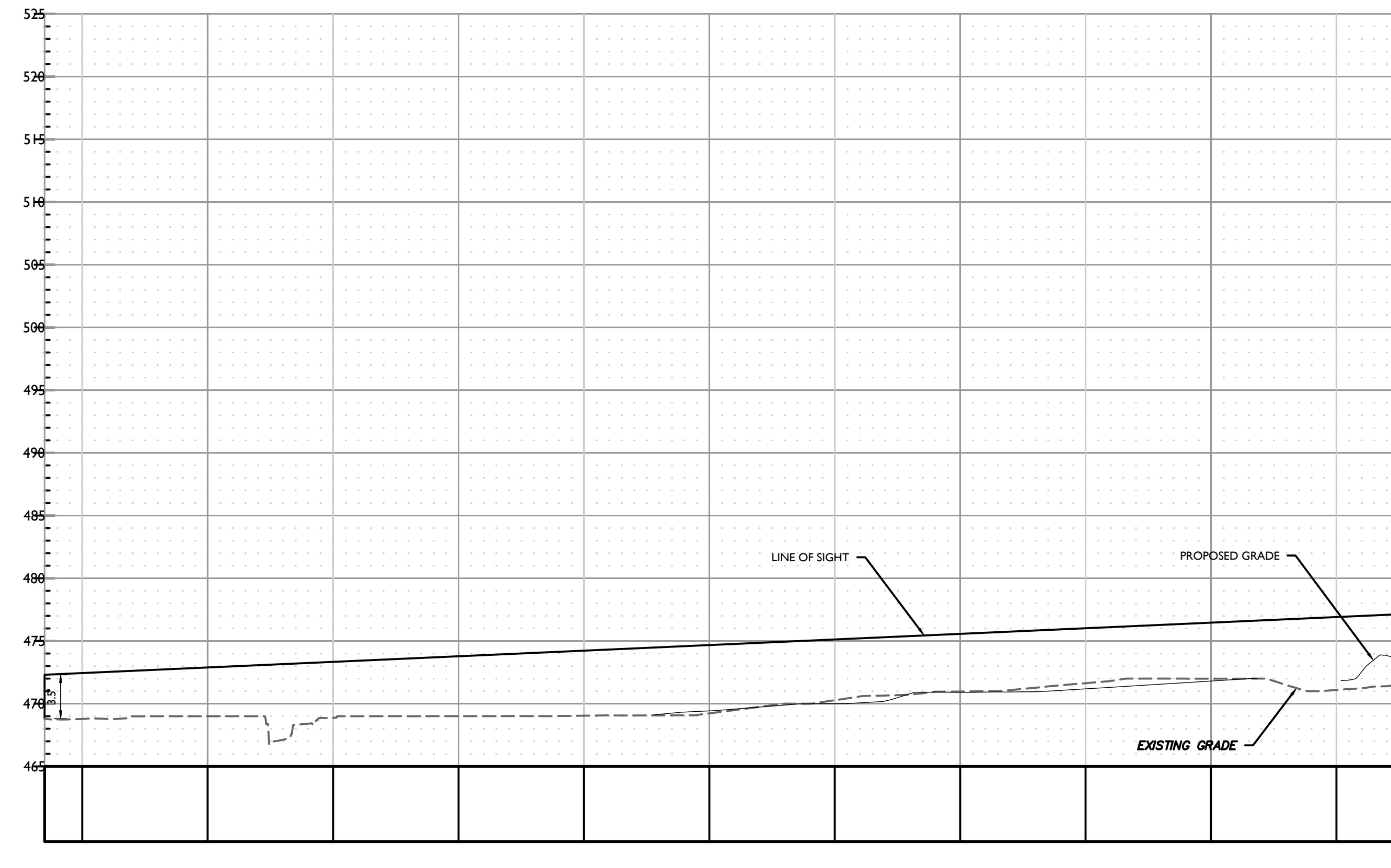

PROFILE OF ISD LOOKING LEFT (SOUTH DRIVE)
 HORIZONTAL : 1" = 40'
 VERTICAL : 1" = 8'

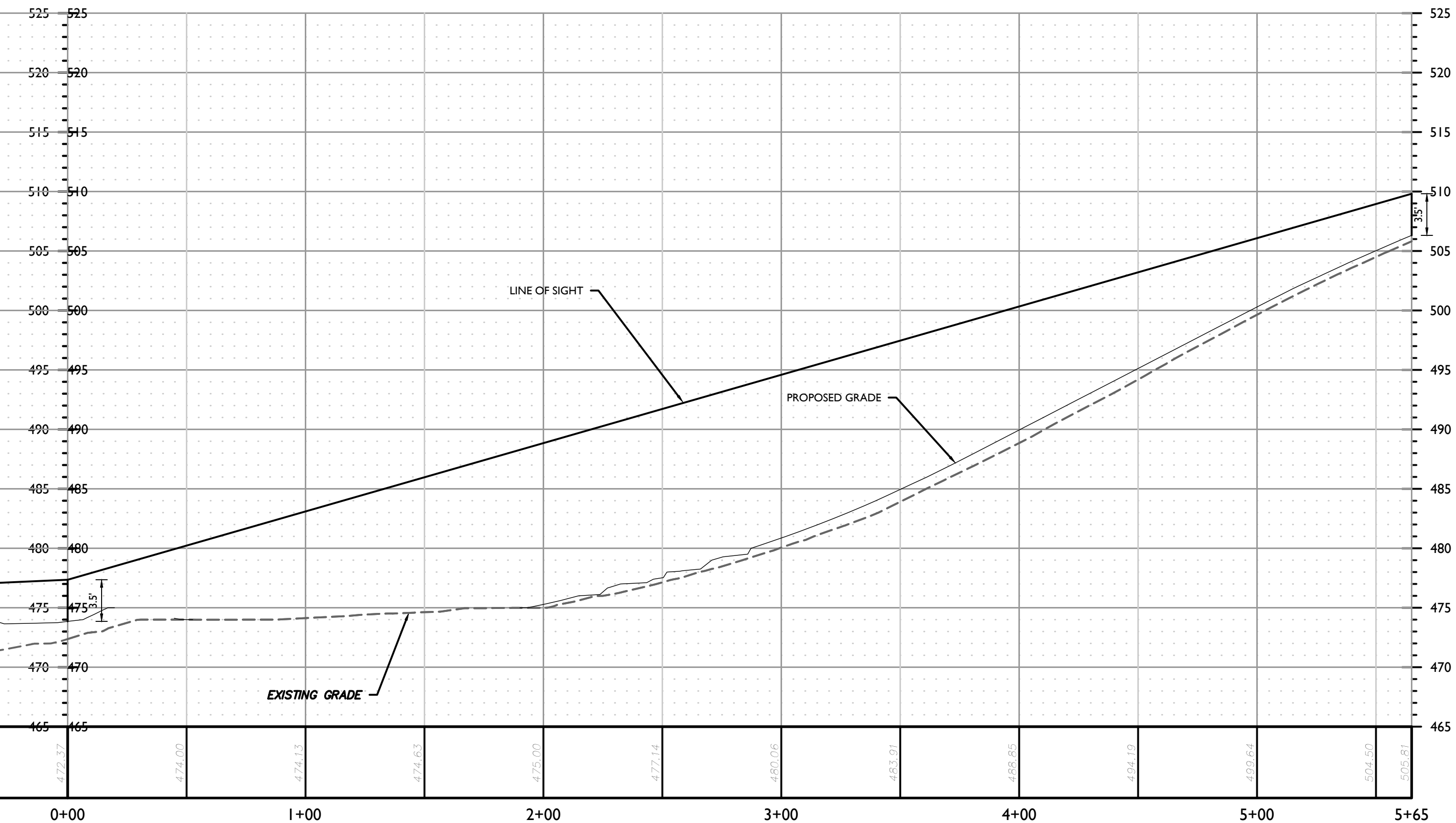

PROFILE OF ISD LOOKING RIGHT (SOUTH DRIVE)
 HORIZONTAL : 1" = 40'
 VERTICAL : 1" = 8'

REV.	DATE	DRAWN BY	DESCRIPTION

Philip John Grealy
 NEW YORK LICENSED PROFESSIONAL ENGINEER
 LICENSE NUMBER: 059858-1
 COLLIERS ENGINEERING & DESIGN CT, P.C.
 N.Y. C.O.A. #: 0077609

SIGHT LINE PROFILES
 FOR
DOLSONTOWN GEIS
RDM DEWPOINT
SOUTH
 SECTION 4,
 BLOCK 1
 LOT 50.32
 TOWN OF WAWAYANDA
 ORANGE COUNTY
 NEW YORK

Colliers 400 Columbus Avenue, Suite 180E, Valhalla, NY 10595
 Engineering & Design Phone: 914.347.7500
 COLLIERS ENGINEERING & DESIGN CT, P.C. DOING BUSINESS AS MASER CONSULTING ENGINEERING & LAND SURVEYING.

SCALE:	DATE:	DRAWN BY:	CHECKED BY:
AS SHOWN	4/3/24	P.W.G.	A.P.R.
PROJECT NUMBER:	DRAWING NAME:	SHEET TITLE:	
20006912A	P-SIGHT	PASSENGER CAR SIGHT DISTANCE	

SHEET NUMBER:
SD-1

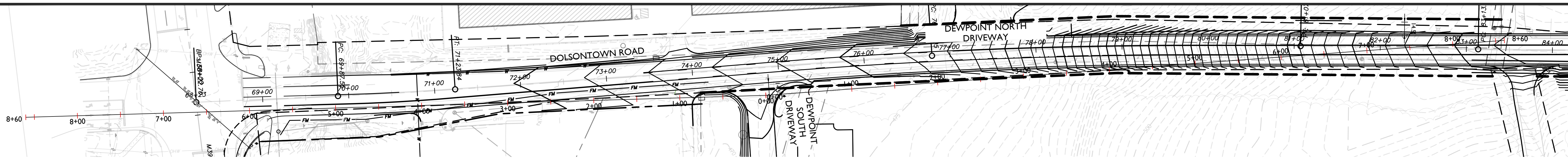

SIGHT DISTANCE SUMMARY TABLE					
ROADWAY DESIGN SPEED	48 MPH	AVAILABLE SIGHT DISTANCE (FT)		AASHTO SIGHT DISTANCES	
		EXISTING	PROPOSED	STOPPING SIGHT DISTANCE (FT)	INTERSECTION SIGHT DISTANCE (FT)
LEFT TURN FROM SITE ACCESS	LOOKING LEFT	860+	860+	400	860
	LOOKING RIGHT	860+	860+	490	860

NOTES:
 1) BASED ON THE AMERICAN ASSOCIATION OF STATE HIGHWAY AND TRANSPORTATION OFFICIALS (AASHTO), 7TH EDITION 2018.
 2) AASHTO SIGHT DISTANCES ARE BASED ON 48 MPH OPERATING SPEED ALONG THE ROADWAY IN THE VICINITY OF THE SITE ACCESS LOCATION FOR COMBINATION TRUCKS, ADJUSTED FOR GRADES AND PROPOSED TWO-WAY LEFT TURN LANE.
 3) AVAILABLE SIGHT DISTANCES SHOWN ARE FOR EXISTING CONDITIONS AND FOR FUTURE CONDITIONS AFTER COMPLETION OF ANY IMPROVEMENTS SUCH AS VEGETATIVE PRUNING/CLEARING AND GRADING.

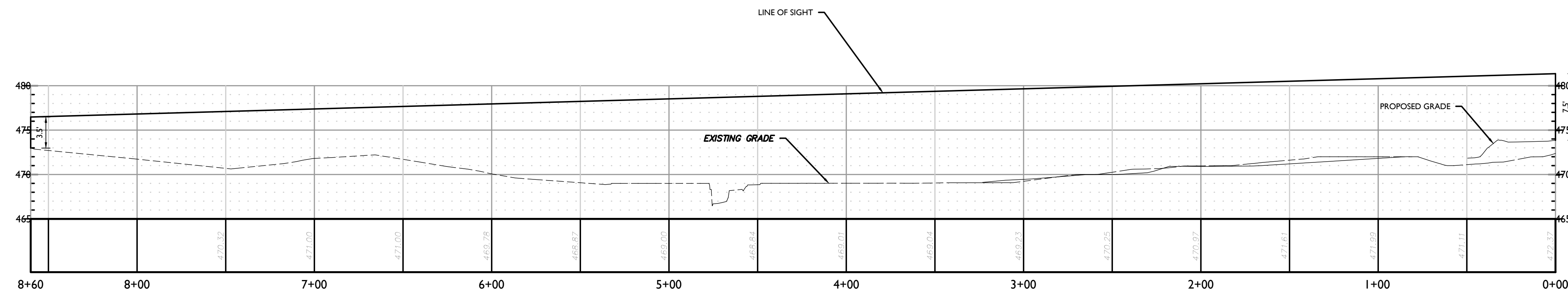
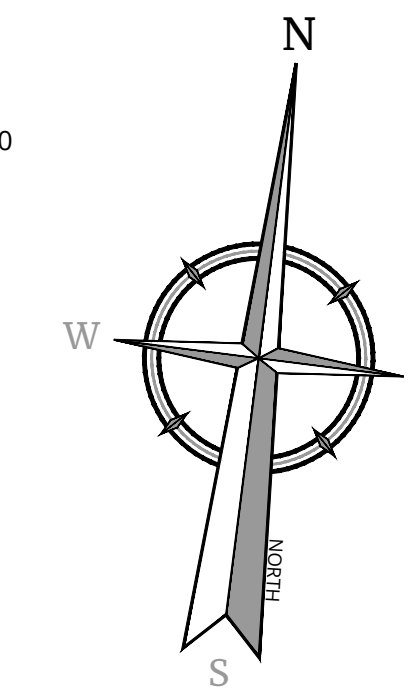
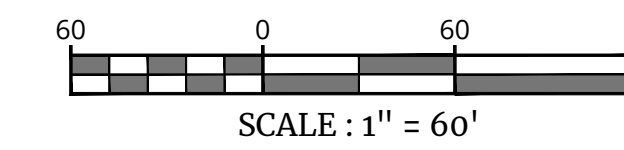

PROFILE OF TRUCK ISD LOOKING LEFT (SOUTH DRIVE)
 HORIZONTAL : 1" = 40'
 VERTICAL : 1" = 8'

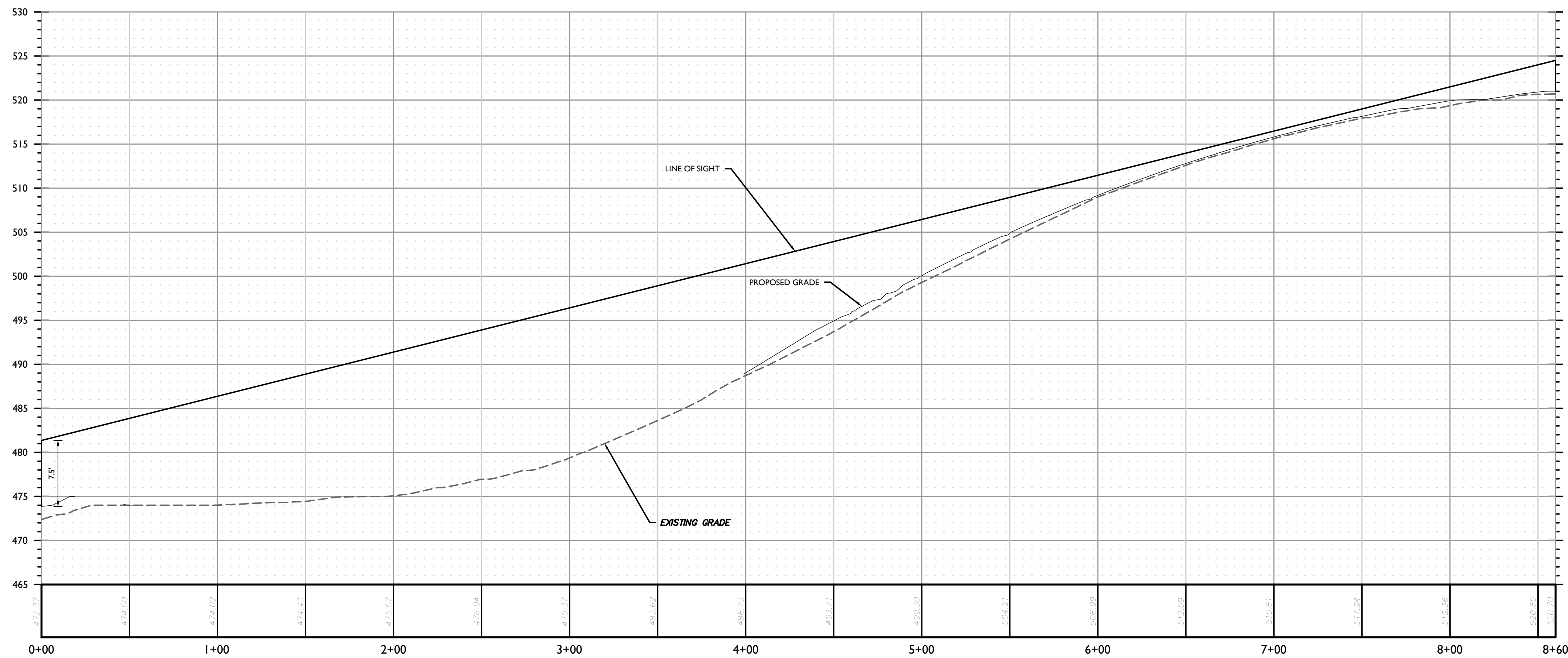

PROFILE OF TRUCK ISD LOOKING RIGHT (SOUTH DRIVE)
 HORIZONTAL : 1" = 40'
 VERTICAL : 1" = 8'

Colliers
 Engineering & Design
 www.colliersengineering.com
 Copyright © 2024, Colliers Engineering & Design All Rights Reserved. This drawing and all the information contained herein is authorized for use only by the party for whom the services were contracted or to whom it is certified. This drawing may not be copied, revised, disclosed, distributed or relied upon for any other purpose without the express written consent of Colliers Engineering & Design.

Doing Business as **MASER CONSULTING**
811 PROTECT YOURSELF
 ALL STATES REQUIRE NOTIFICATION OF EXCAVATORS, DESIGNERS, OR ANY PERSON PREPARING TO DISTURB THE EARTH'S SURFACE ANYWHERE IN ANY STATE
 Know what's below. Call before you dig.
 FOR STATE SPECIFIC DIRECT PHONE NUMBERS VISIT: WWW.CALL811.COM

REV	DATE	DRAWN BY	DESCRIPTION

Philip John Grealy
 NEW YORK LICENSED PROFESSIONAL ENGINEER
 LICENSE NUMBER: 059858-1
 COLLIERS ENGINEERING & DESIGN CT, P.C.
 N.Y. C.O.A. #: 0017609

SIGHT LINE PROFILES
 FOR
DOLSONTOWN GEIS
RDM DEWPOINT
SOUTH
 SECTION 4,
 BLOCK 1
 LOT 50.32
 TOWN OF WAWAYANDA
 ORANGE COUNTY
 NEW YORK

Colliers WESTCHESTER
 400 Columbus Avenue,
 Suite 180E
 Valhalla, NY 10595
 Phone: 914.347.7500
 COLLIERS ENGINEERING & DESIGN CT, P.C.
 DOING BUSINESS AS MASER CONSULTING
 ENGINEERING & LAND SURVEYING

SCALE: AS SHOWN DATE: 4/3/24 DRAWN BY: P.W.G. CHECKED BY: A.P.R.
 PROJECT NUMBER: 20000912A DRAWING NAME: R-SIGHT

SHEET TITLE: **COMBINATION TRUCK SIGHT DISTANCE**
 SHEET NUMBER: **SD-1A**

2025/09/08 10:24 AM Transportation/Civil/AS/SP/PT/46253-1A Rev: R02/MT/ELP